

PF Filter Fans

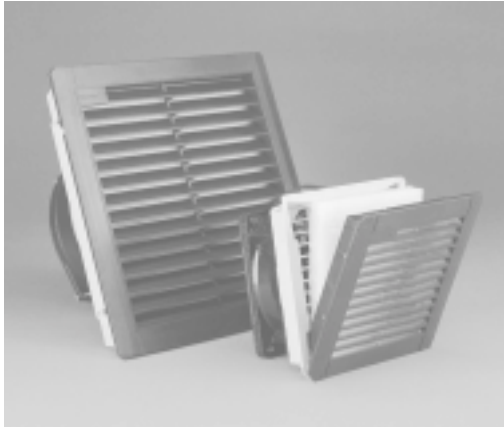

PF3000 and PF2000

Description

- This line of fans provides innovative technology for fan cooling and pressurizing of industrial cabinets. A high quality filter fan provides an economical method of ensuring your enclosure does not overheat.
- Filtered passive ventilation can be provided by an exhaust filter for either convection cooling or in combination with a fan in forced air cooling.
- The slim-line design of this fan line is unique, when installed, the front louvered grill protrudes less than one quarter inch. The attractive grill maintains the sleek aesthetics of an enclosure system.

Standards

- UR, CUR and CE.
- Built to IP54 standards (except PF1000/PFA1000 - IP43 standards).
- Maintains NEMA 12 integrity of enclosure

Features

- Available in 115V and 230V versions
- High performance fan motors with finger guards.
- ABS-FR grills (except PF1000 Series which is polystyrene FR).
- Durable, reusable filter mat.
- Grills are black allowing for a complementary match to all cabinet colors.
- Integral gasket to seal against enclosure. (except PF1000 - use PFG1000)

Easy Installation

- The patented "Click and Fit" system allows for rapid filter fan and exhaust filter installation without screws.
- After using the convenient cutout template (provided with every unit), the fan and/or exhaust filter just snaps into the opening.

Accessories

- Exhaust filters...see page 362
- Replacement grills...see page 362
- Replacement filters...see page 362

Climate Control Products
Filter Fans

Part No.	Voltage	Free Flow Air Delivery (CFM)	Air Delivery w/Exhaust (CFM)	Max. Static Pressure (Pa)	Filter Density (g/m ²)	Filtering Level (%)	Sound Level (dB)	Connector Type	Ambient Temp. °F Max/Min	Comparable IP Standard	Ship Wt. lbs
PF1000	115	16	10	29	150	73%	39	2 - 12" wires	140/14	IP43	3
PF2000	115	38	28	69	150	73%	49	terminal strip	122/14	IP54	5
PF2500	115	89	62	57	150	73%	55	terminal strip	122/14	IP54	7
PF3000	115	169	142	89	150	73%	55	terminal strip	122/14	IP54	10
PF5000	115	324	249	205	150	73%	69	terminal strip	122/14	IP54	15
PF6000	115	410	295	225	150	73%	71	terminal strip	122/14	IP54	15
PF1000230	230	16	10	29	150	73%	39	2 - 12" wires	140/14	IP43	3
PF2000230	230	38	28	69	150	73%	49	terminal strip	122/14	IP54	5
PF2500230	230	89	62	57	150	73%	55	terminal strip	122/14	IP54	7
PF3000230	230	169	142	89	150	73%	55	terminal strip	122/14	IP54	10
PF5000230	230	324	249	205	150	73%	69	terminal strip	122/14	IP54	15
PF6000230	230	410	295	225	150	73%	71	terminal strip	122/14	IP54	15

Technical references and DXF downloads available at www.hammfg.com

All dimensions in inches unless specified otherwise

PF Filter Fans

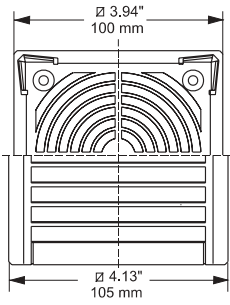

PF1000

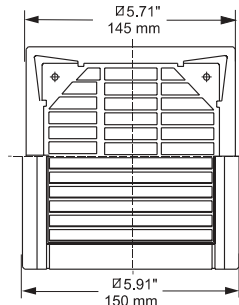
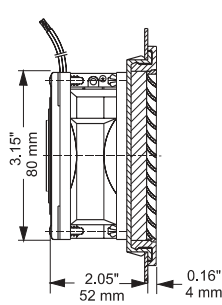

PF2000

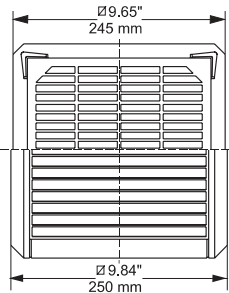
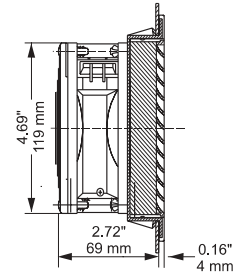

PF2500

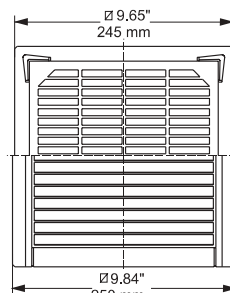
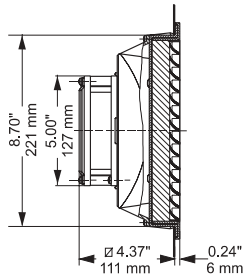

PF3000

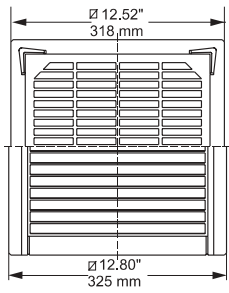
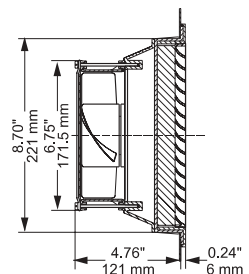

PF5000

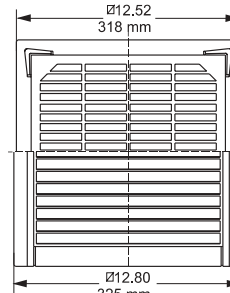
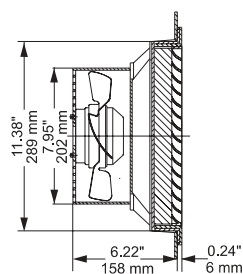

PF6000

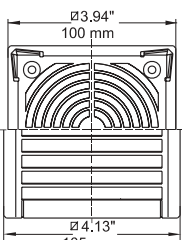
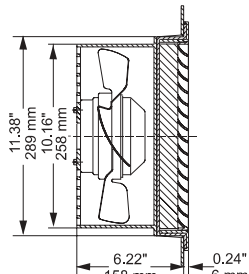

PFA1000

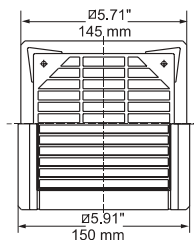
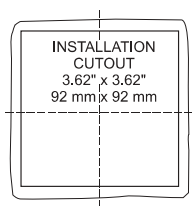
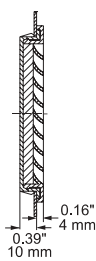

PFA2000

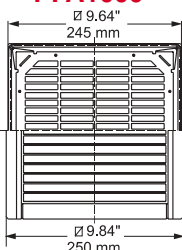
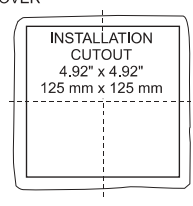
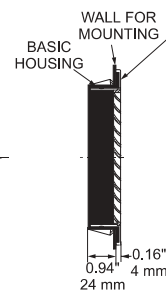

PFA3000

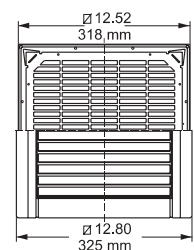
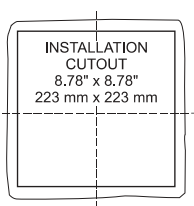
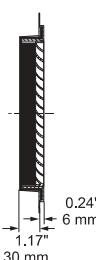

PFA5000

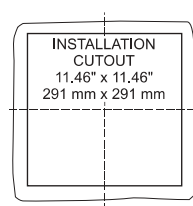
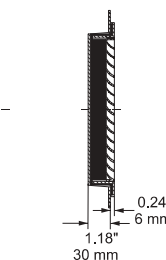

Note: All cutout tolerances +/- 0 mm

Technical references and DXF downloads available at www.hammfg.com

All dimensions in inches unless specified otherwise

Climate Control Products
Filter Fans